

RoHS 2.0

| REV. | ECN NO. | DESCRIPTION | DATE     | DESIGN |
|------|---------|-------------|----------|--------|
| A0.  | /.      | 正式版发行       | 22.10.25 | LZR    |

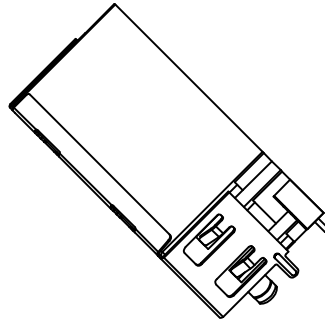
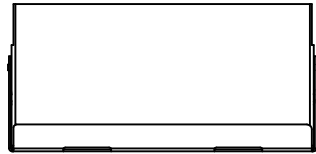

3D VIEW

NOTES:

- MATERIAL:
    - HOUSING:PBT ,COLOR IS BLCAK;
    - CONTACT:PHOSPHOR BRONZE,Ø0.46±0.02mm;
  - FINISH:PLATED GOLD OVER NI;
  - REINNEBDED PCB THICKNESS: 1.60mm;
  - ELECTRICAL:
    - VOLTAGE RATING: 125 VAC RMS;
    - CURRENT RATING: 1.5 AMP;
    - CONTACT RESISTANCE: 30MILLIOHMS MAX.;
    - WITHSTAND VOLTAGE: 1000 VAC RMS
- 50(60)Hz,1MIN.;
- INSULATION RESISTANCE: 500MEGOHMS MIN @500V DC;
  - MECHANICAL:
    - MATING/UNMATING FORCE: 30N MAX.;
    - RENTIION STRENGTH: 50N MIN.;
    - OPERATING LIFE: 750 CYCLES MIN.;
  - SALT SPRAY TEST:12H;
  - SOLDERABILITY: 245±5°C,5±0.5S;
  - RESISTANCE TO SOLDER:260±0.5°C,10±1S;
  - ENVIRONMENTAL:
    - STORAGE TEMPERATURE RANGE:-40°C~+85°C;
    - OPERATION TEMPERATURE RANGE:-25°C~+70°C;
  - THE MARK WITH "\*" IS THE KEY INSPECTION DIMENSION FOR QC.

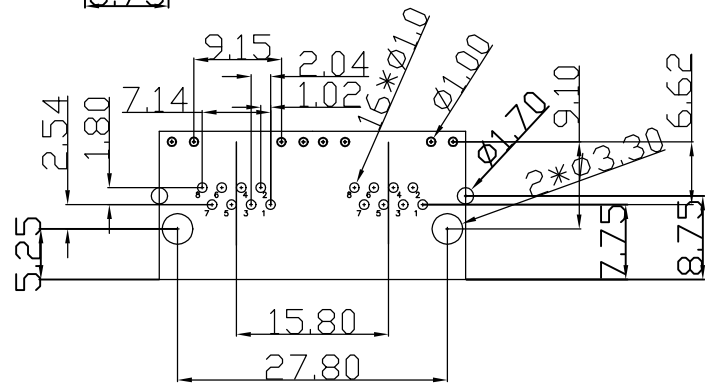
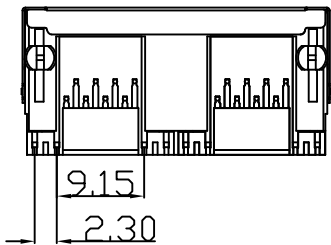
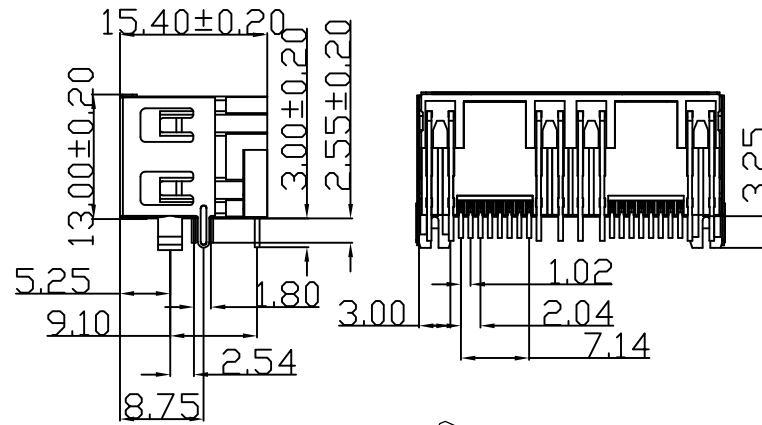
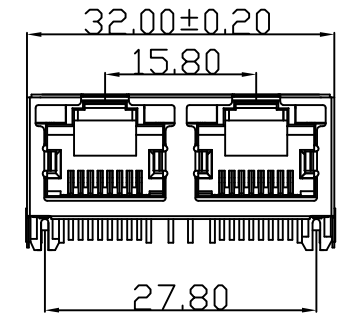

RECOMMENDED PCB LAYOUT  
TOP VIEW(TOL:±0.05)

|    |    |     |            |    |
|----|----|-----|------------|----|
| C  | 外壳 | 黄铜  | 镀镍         |    |
| B  | 端子 | 磷铜  | 镀镍 镀金(G/F) |    |
| A  | 基座 | PBT | 黑色         |    |
| 序号 | 品名 | 材质  | 电镀/颜色      | 备注 |

# 深圳市虹成电子有限公司

|   |                            |                            |               |             |               |
|---|----------------------------|----------------------------|---------------|-------------|---------------|
| UNLESS OTHERWISE, GENERAL TOLERANCE:<br>X. xxx ±0.10<br>X. xx ±0.20<br>X. x ±0.30 | NAME:<br>RJ45 双口半包带灯       | P/N:<br>HC-WK88-H16-1X2-DB |               |             |               |
|   | THIRD ANGLE PROJECTION<br> | UNIT:<br>MM                | SCALE:<br>1:1 | SIZE:<br>A4 | SHEET:<br>1/1 |
| ANGULAR:<br>X. xx° ±1°<br>X. x° ±3°<br>X. ° ±5°                                   | DRAWN:                     | CHECKED:                   | APPROVED:     |             |               |