

2	3	4	5	6	7	8	9
标记 MARK	ECN编号/变更内容 ECN NO/DEFINITION	修改 REVISE	日期 DATE	核准 APPROVE			

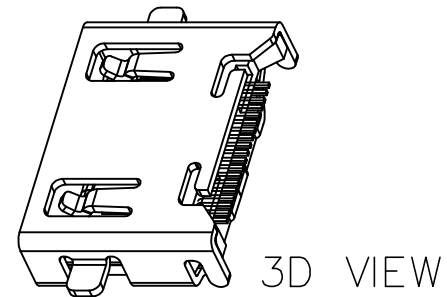

NOTES

1. MATERIAL:
  - 1.1. HOUSING: LCP, COLOR IS BLACK;
  - 1.2. CONTACT: BRASS (H65 T=0.20mm);
  - 1.3. SHELL: COLD ROLLED IRON (SPCC,T=0.5mm);
2. FINISH:
  - 2.1. TERMINAL:
    - CONTACT AREA: GOLD PLATED G/Fu";
    - SOLDER AREA: PLATED OVER TIN;
  - 2.2. SHELL: NI PLATED OVER ALL ;
4. ELECTRICAL:
  - 4.1. VOLTAGE RATING: 40 VAC RMS;
  - 4.2. CURRENT RATING: 0.5 AMP;
  - 4.3. CONTACT RESISTANCE: 30mΩ MAX.;
  - 4.4. WITHSTAND VOLTAGE: 500 VAC RMS  
50(60)Hz,1MIN.;
  - 4.5. INSULATION RESISTANCE: 100MEGOHMS MIN  
@500V DC;
5. MECHANICAL:
  - 5.1. MATING FORCE: 44.1N MAX.;
  - 5.2. UNMATING FORCE: 9.8N MIN.;
  - 5.3. OPERATING LIFE: 10000 CYCLES MIN.;
6. ENVIRONMENTAL:
  - 6.1. STORAGE TEMPERATURE RANGE: -40°C~+85°C
  - 6.2. OPERATION TEMPERATURE RANGE: -25°C~+70°C;
- 7.SALT SPRAY TEST:24H(Salt spray test 24hours for gold plated area and 8 hours for tin plated area)

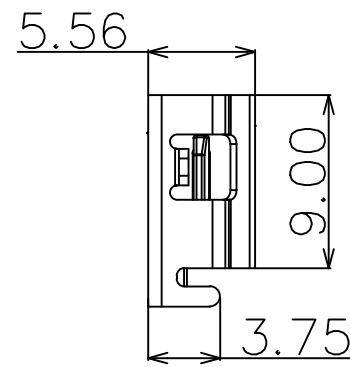
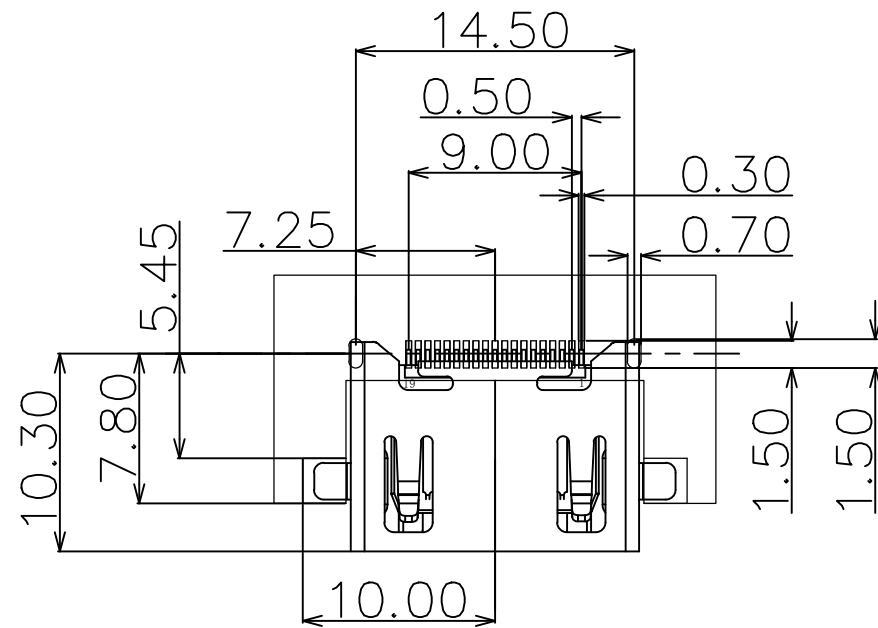
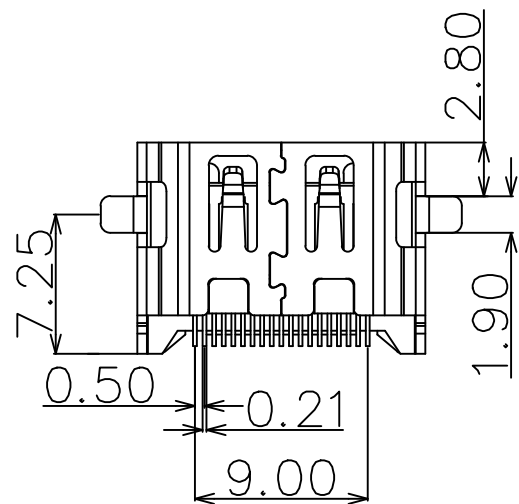
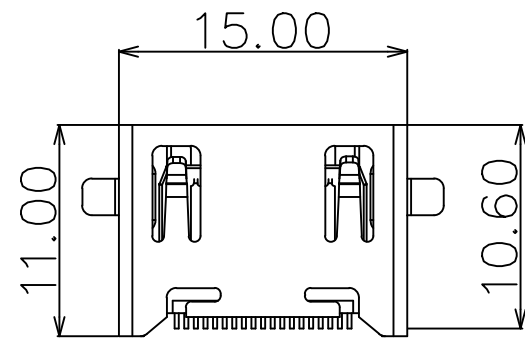
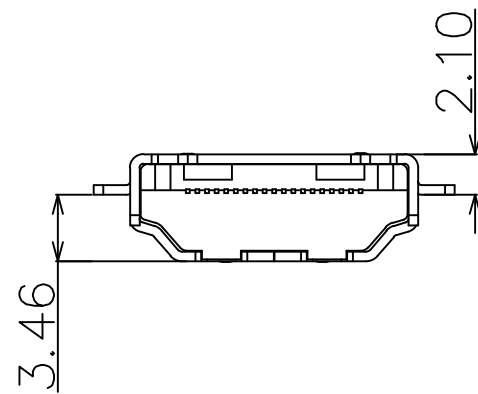
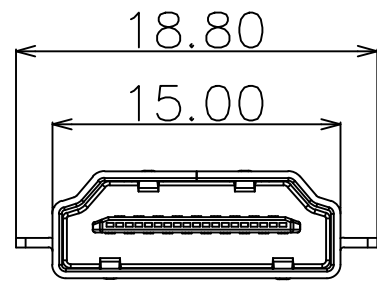

RECOMMEND PCB LAYOUT  
TOLERANCE: ±0.05 T=1.2  
TOP VIEW

3	外壳	铁	镀镍	
2	接触	铜	镀金	
1	基座	LCP	黑色	
序号	品名	材质	电镀/颜色	备注

	深圳市虹成电子有限公司 品名 TITLE 料号 PART NO		HDMI座 HC-HDMI0019T-3	
	UNLESS GENERAL TOLERANCE: X.xxx ±0.10 X.xx ±0.20 X.x ±0.30 ANGULAR: X.xx° ±1° X.x° ±3° X° ±5°	比列 SCALE 1:1 单位 UNIT MM 张数 PART NO 1 OF 1 版本 REV A	制图 DRAW AhYe 审核 CHECKED 夏操云 批准 APPROVE 赵亮亮	